

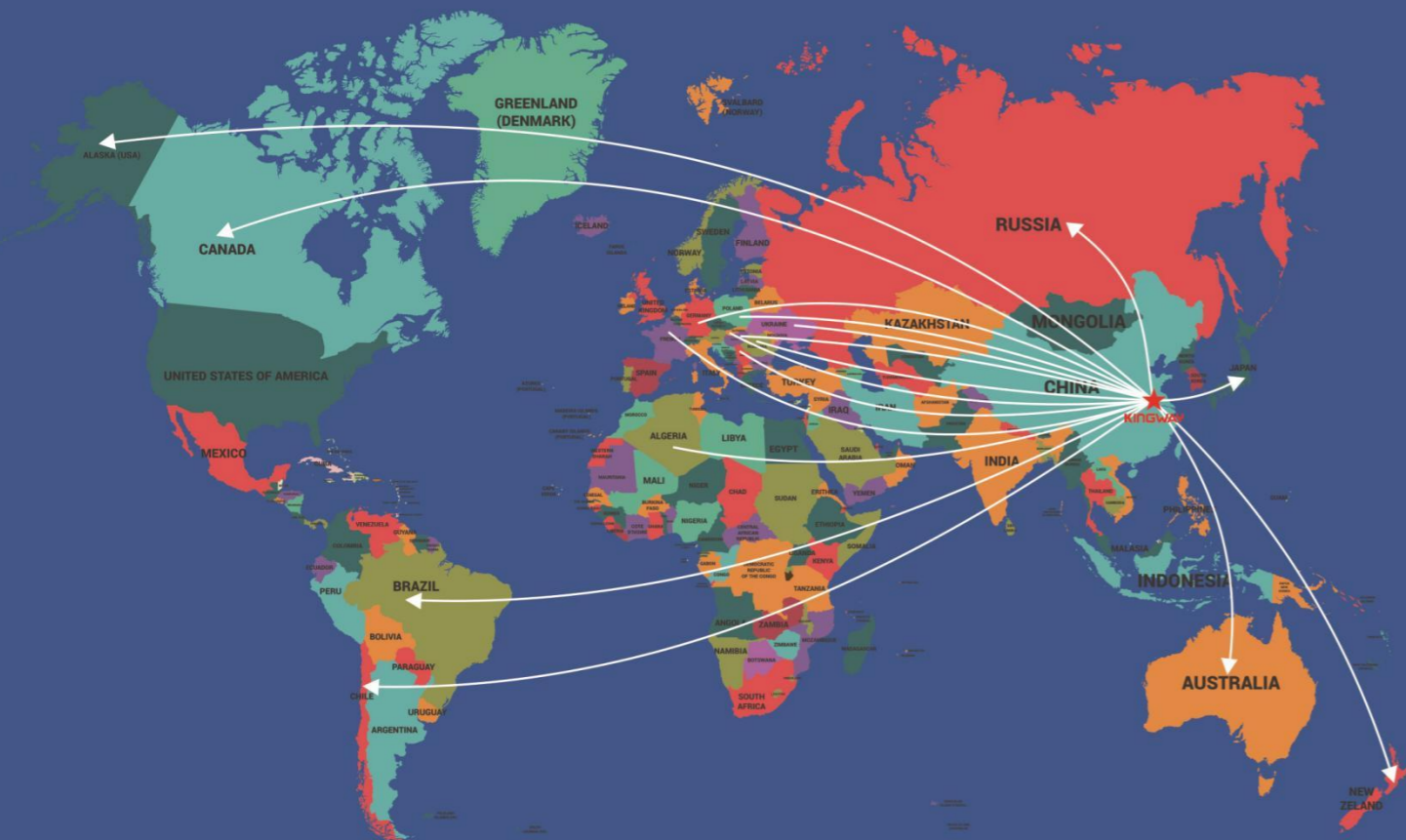

关注我们

合作·共赢·创新·发展

MUTUAL BENEFIT COOPERATION AND INNOVATION



地址：江苏省南通市海安市康华路59号
电话：0513-88780565
网址：[//www.hekway.com](http://www.hekway.com)
邮箱：terry@hekway.com

Add:No.59,Kanghua Road Haian Development Zone, Nantong, Jiangsu, China
Tel:0513-88780565 Whatsapp:+8613813799788
Web:[//www.hekway.com](http://www.hekway.com)
Email:terry@hekway.com



南通金威复合材料有限公司

NAN TONG KINGWAY COMPLEX MATERIAL CO.,LTD.

南通海科威建材有限公司

NAN TONG HEKWAY BUILDING MATERIAL CO., LTD.

资质篇

Qualification article



CONTENTS

目录

公司概况/Company profile

资质荣誉 01-02
Honor of qualification
公司简介 03-04
Brief introduction
设备与研发 05-06
Equipment and testing

建筑材料/Building material

防水透汽膜 07-12
waterproof breathable membrane
隔汽膜 13-14
vapour barrier
隔热膜(铝箔隔热垫层) 15-18
Aluminum foil
防水膜/防水垫板 19-20
waterproof membrane/ waterproof backer board

医用材料/medical material

无纺布 21-22
PP nonwoven fabric
熔喷/PE透汽膜 23-24
Meltblown/PE breathable film
医用防护 25-26
Meltblown/disposable medical products

家居包装/Home packaging

PE网格布/包装材料 27-28
PE mesh/packing material
营销网络 29-30
marketing network



公司简介 
ABOUT US

南通金威复合材料有限公司（南通海科威建材有限公司）坐落于中国长三角发达的新能源产业基地——中国江苏海安，地处新长铁路、宁启铁路、328国道、204国道以及沿海高速、江海高速交汇处，交通运输十分便利。南通金威是集研发、生产和销售为一体的大型企业。专业化生产防水透汽膜，防水隔汽膜，呼吸纸，阻燃型防水透汽膜。我们的主要产品包括低透汽防水透汽膜、高透汽防水透汽膜、隔汽膜、阻隔膜、反射隔热膜、吸音无纺布、PP纺粘无纺布、复合无纺布、防水隔热垫层、防水透汽垫层、呼吸纸、建筑防水透汽膜、钢结构屋面专用防水透汽膜。公司通过美国ICC-ES验厂，英国BBA验厂，PP纺粘无纺布、防水透汽膜产品通过国家建材检测中心检测和欧洲CE认证以及英国BBA认证。在全球倡导节能环保的今天，南通金威以一流的生产技术和产业优势，在绿色保温建材行业独树一帜。卓越的品质，完善的服务，便捷的交通，快递及时的物流系统，使【金达威】品牌产品覆盖全国各省、直辖市和自治区，广泛应用于幕墙、钢结构、木结构、别墅等，并出口欧美、非洲、俄罗斯、澳大利亚、日本及东南亚等国家。

南通金威一直践行【创新，求实，拼搏，奉献】的价值观，以【奉献节能精品，锻造民族品牌】为己任，通过专业的生产技术，严谨的管理，超卓的设备，着力打造优质环保节能精品，为追求成为值得信赖和尊重的绿色新型建材企业而不懈努力。

Nantong Kingway Complex Material CO., Ltd (Nantong Hekway Building Material CO., Ltd) is a leading professional manufacturer in China, which locates in Haian State-grade Development Zone, Jiangsu Province. Our main products:

- 1: nonwoven fabric, composite nonwoven fabric, film laminated nonwoven fabric;
- 2: PE or PP breathable film ; 3: Building material: breathable roofing underlayment and housewrap, vapor barrier, heat insulation membrane and foil ; 4: Medical material: disposable medical product, medical bed sheet, protective coverall ; 5: Packing material ; 6. Household product.

We not only have first-class processing line, but have first-grade quality management. We have been qualified by ISO9001 (quality) and CE, this system can supply active way to guarantee the quality. We have exported to many countries, such as Canada, USA, Chile, Argentina, New Zealand, Australia, Malaysia, Japan, Ukraine, Latvia, Slovenia, Slovakia, Spain, CZ, Russia, Croatia, Bulgaria, Romania, Italy, UK, Germany, Greece and so on.



设备与研发

EQUIPMENT & RESEARCH TESTING



仓库一角

A CORNER OF THE WAREHOUSE

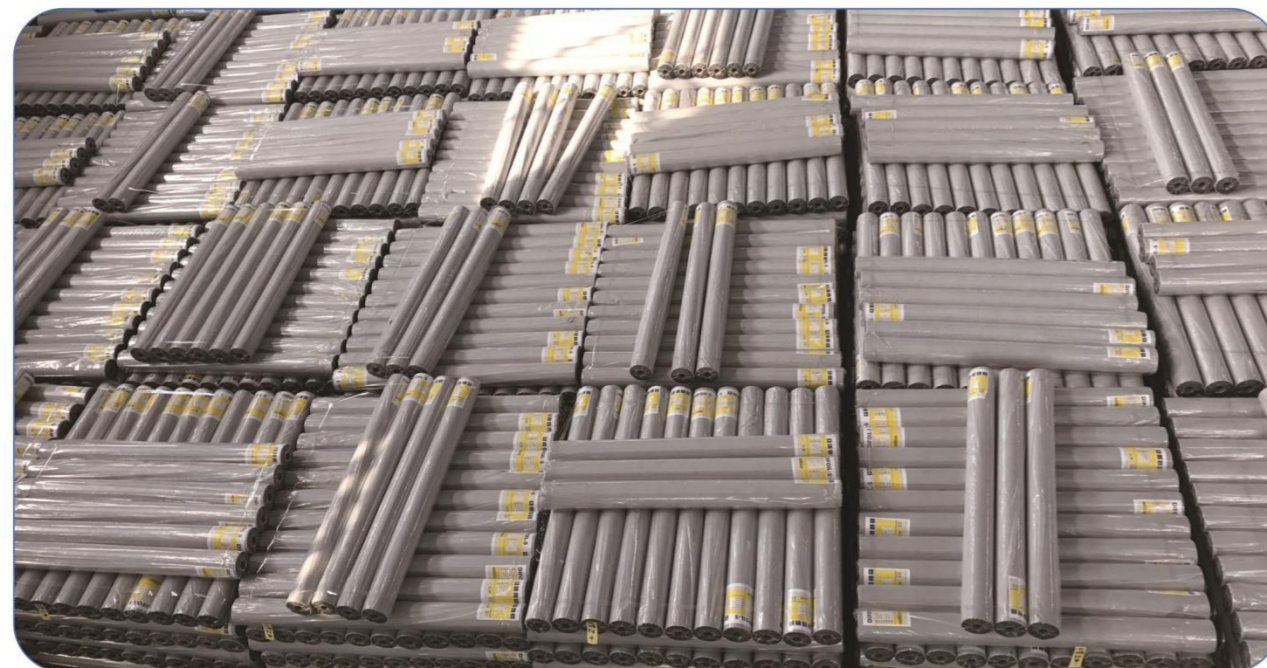

拉伸强度检测仪器
Tensile Strength



静水压检测仪器
Hydrostatic Pressure



克重检测仪器
Weight



阻燃检测仪器
Flame Retardant



透湿量检测仪器
Moisture permeability



抗老化检测仪器
Anti-aging

高效团队，一流设备，追求科技创新，打造上乘品质 Efficient team, first-class equipment

我公司拥有一支多年专业从事防水材料研发的团队，并与国内外相关科研机构紧密合作，共同开发新产品，通过技术创新，完善企业经营管理，逐步占领防水材料的主要市场，成为国内国外防水透汽膜主要生产企业。同时公司拥有一流的生产和检测设备，为产品质量提供了有力保证。

Our company has a team that has been engaged in the research and development of waterproof materials for many years, and cooperates closely with relevant scientific research institutions at home and abroad to jointly develop new quality, through technological innovation, improve business management, gradually occupy the main market of waterproof materials, and become a domestic and foreign company. , The main manufacturer of waterproof and breathable membranes. At the same time, the company has first-class production and testing equipment, which provides a strong guarantee for product quality.

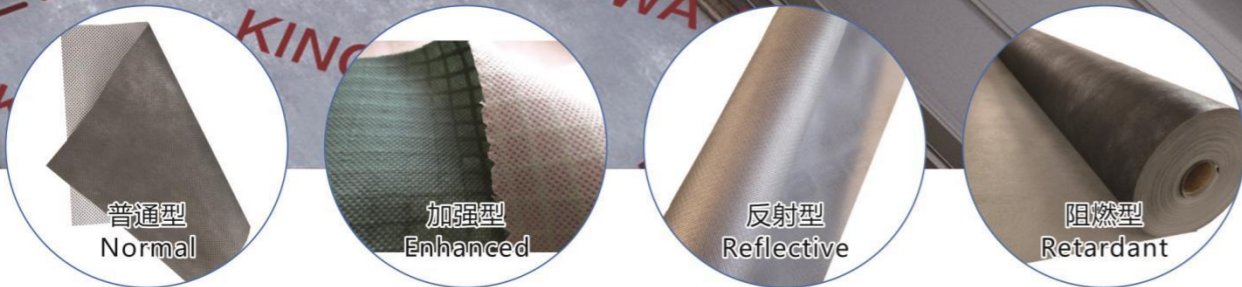
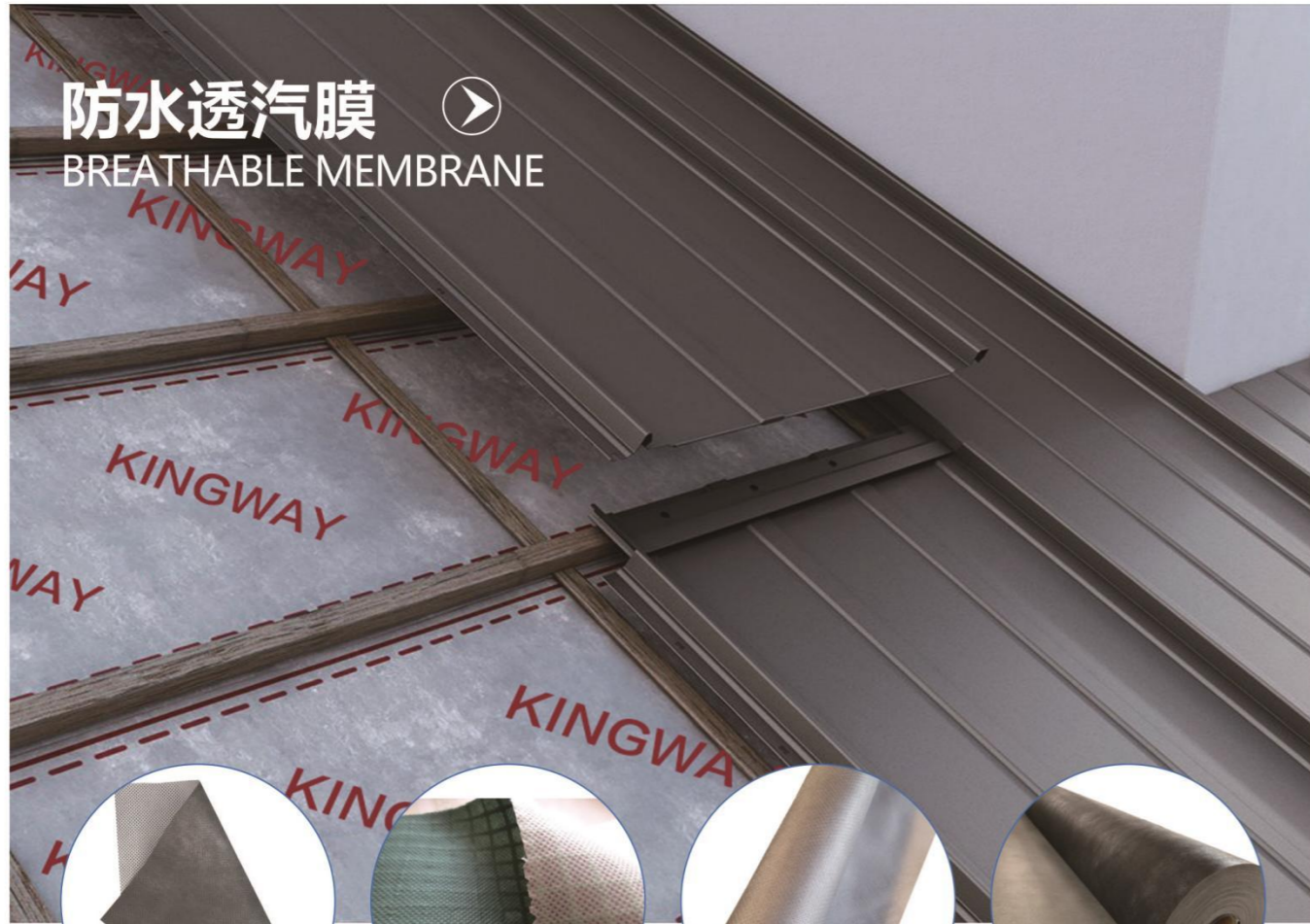

金达威防水透汽膜由中间层聚烯烃微孔膜以及两层高分子材料经先进的热复合工艺生产而成，金达威防水透汽膜（呼吸纸）采用耐久性好，抗紫外线的聚烯烃材料，能阻止热空气，冷空气和湿气渗透到您的屋里，加强建筑的气密性，水密性的同时，能提供独一无二的透气性。产品铺在建筑屋面或外墙保温层之上，顺水条之下，使围护内潮气顺利排出，从而有效保持建筑物的使用寿命，起到保温、节能、改善居住环境的功能。



Kingway waterproof breathable membrane consists of a middle layer of polyolefin microporous membrane and two layers of polymer materials, Produced by advanced thermal compounding process, Jindawei waterproof vapor permeable membrane (breathing paper) adopts, Durable, UV-resistant polyolefin material can block hot air, cold air and moisture, Penetrate into your house, strengthen the air-tightness and water-tightness of the building, while providing unique Unparalleled breathability. The product is spread on the building roof or external wall insulation layer, along the water strip, So that the moisture inside the enclosure can be discharged smoothly, so as to effectively maintain the service life of the building. To the functions of heat preservation, energy saving, and improvement of the living environment.

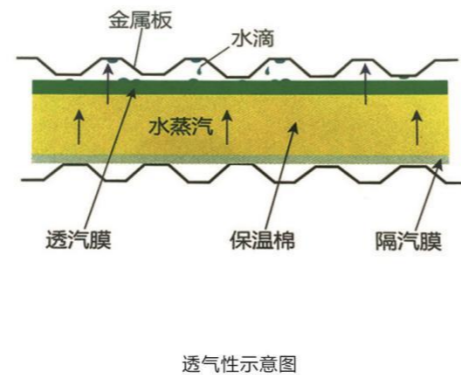
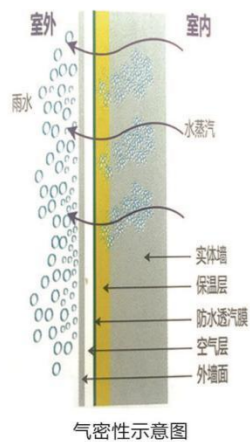



防水透汽膜

BREATHABLE MEMBRANE



C80



C100



C150



C180



C120



C140



C205



FC130

型号 MODEL	C80	C100	C120	C140
克重/weight(g/m ²)	80±5	100±5	120±5	140±5
防火/Reaction to fire	Class E	Class E	Class E	Class E
静水压/ water penetration	Class W1	Class W1	Class W1	Class W1
water penetration after aged	Class W1	Class W1	Class W1	Class W1
宽度/width	1M,1.5M.3M	1M,1.5M.3M	1M,1.5M.3M	1M,1.5M.3M
拉力(N/50mm) Tensile strength	MD 140±40 CD 100±40	MD 180±50 CD 110±50	MD 240±50 CD 150±50	MD 260±50 CD 180±50
拉力(N/50mm) Tensile strength after aged	MD 120±40 CD 80±40	MD 160±40 CD 100±40	MD 180±40 CD 120±40	MD 210±40 CD 140±40
Elongation(%)	MD 50±30 CD 50±30	MD 60±30 CD 65±30	MD70±30 CD 80±30	MD75±30 CD 90±30
Elongation after aged	MD 45±20 CD 45±20	MD 40±20 CD 50±20	MD 60±20 CD 70±20	MD 70±20 CD 80±20
UV	3 month	3 month	3 month	3 month
SD	0.02±0.015	0.02±0.015	0.02±0.015	0.02±0.015

型号 MODEL	C150	C180	C205	FC130
克重/weight(g/m ²)	150±5	180±5	205±5	130±5
防火/Reaction to fire	Class E	Class E	Class E	Class E
静水压/ water penetration	Class W1	Class W1	Class W1	Class W1
water penetration after aged	Class W1	Class W1	Class W1	Class W1
宽度/width	1M,1.5M.3M	1M,1.5M.3M	1M,1.5M.3M	1M,1.5M.3M
拉力(N/50mm) Tensile strength	MD 280±40 CD 200±40	MD 320±50 CD 250±50	MD 300±50 CD 260±50	MD 240±50 CD 180±50
拉力(N/50mm) Tensile strength after aged	MD 220±40 CD 160±40	MD 260±40 CD 180±40	MD 270±40 CD 180±40	MD 200±40 CD 140±40
Elongation(%)	MD70±30 CD 90±30	MD 75±30 CD 80±30	MD70±30 CD 80±30	MD75±30 CD 80±30
Elongation after aged	MD 50±20 CD 60±20	MD 56±20 CD 65±20	MD 60±20 CD 70±20	MD 70±20 CD 80±20
UV	3 month	3 month	3 month	3 month
SD	0.02±0.015	0.02±0.015	0.02±0.015	0.02±0.015
反射比/Reflectance				83%



防水透汽膜的工作原理

BREATHABLE MEMBRANE

防水透汽膜工作原理可分为微孔和亲水基团两种，金达威防水透汽膜则采用前者，由于水滴的最小直径与水汽的直径存在着巨大差异，水蒸汽可藉扩散原理通过微孔膜，液态水或者水滴因其表面张力的作用，使水分子无法通过，也就防止了水的渗透发生，使透汽膜有了防水的功能。

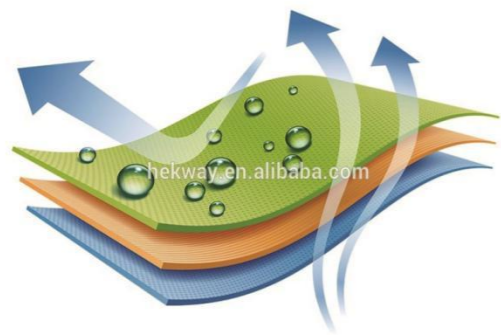

普通型防水透汽膜

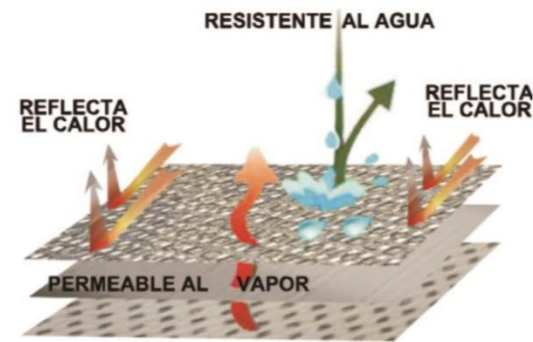

反射型防水透汽膜

防水透汽膜对建筑的改善

- 1、金达威 (Kingway) 防水透汽膜铺装在保温层之外，将整个建筑包覆起来，从而减少空气泄漏和对流热损失，有效加强建筑的气密性。
- 2、金达威 (Kingway) 防水透汽膜卓越的防水性能，严密的包覆，保护建筑不受水汽及雨水的侵蚀。有效保证建筑的保温效果及耐久性，使建筑更加节能、环保。
- 3、金达威 (Kingway) 防水透汽膜铺装于保温层之外，能够保证围护结构内水汽有效排出，降低屋面结露风险，解决结露防潮问题，保护保温层。
- 4、金达威 (Kingway) 防水透汽膜铺设于顺水条之上，针眼在至高点，雨水沿顺水条顺势而下并自由排出，防水更有保证。
- 5、金达威 (Kingway) 防水透汽膜保护保温层，保温层之上不需要再做细石混凝土或涂膜防水材料，可降低工程造价。

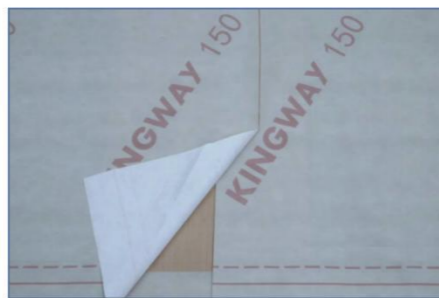

A three layer highly breathable, fully waterproof membrane, constructed from high tensile spun-bonded polypropylene layers, around a microporous polypropylene film. The outer layer forms the functional waterproof surface; the middle layer is the breathable waterproof membrane and the inner layer protects the membrane from abrasion and damage, also giving additional strength. This enables the fabric to allow moisture vapour to pass through, whilst remaining fully waterproof. We can provide various colors on upper surface, printed with the trade name and head lap lines.

Use: Breathable roofing underlay positioned immediately above the insulation layer in a warm pitched roof, or in a cold pitched roof (ventilated or unventilated). Breathable roofing underlay for use under tiles and sheeted roofs, over open rafters or on to fully boarded substrates. Breather membrane for timber frame wall construction.

Features: High performace breather membrane

Constructed from high tensile spun-bonded polypropylene layers

Higher levels of water resistance

Full moisture vapour permeability

Breathable underlay for tiled and slated pitched roofs

Eco-friendly to be completely recyclable.

Breathability: from 0 to 3000guare meter/24hours

Weight: 80--230g/m²

Roll size: 1.5m x 50m (75m²) or at the buyer's option

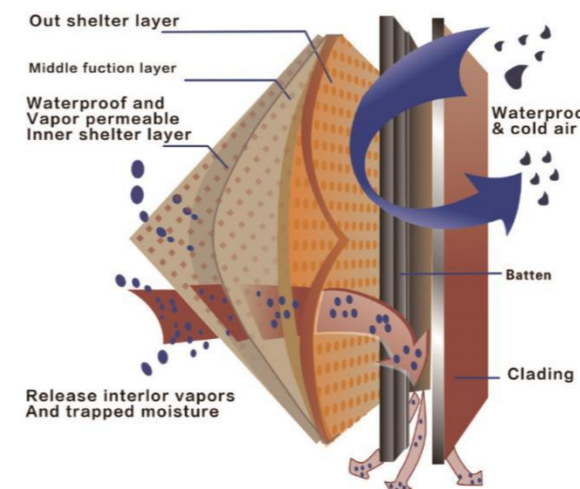

- ★ Water resistant breathable
- ★ Good UV resistant anti-aging
- ★ Light weight simple handing
- ★ For pitched roof wall lissge
- ★ Good quality favorable price



隔汽膜

VAPOR BARRIER

产品描述

一、金达威隔汽膜铺设于基础层之下，加强建筑物水密性的同时防止室内潮湿气向保温层渗透，使保温层不受侵蚀。

二、金达威隔汽膜与保温层之上的防水透汽膜配套使用，可令墙体或屋面获得绝佳的水汽隔绝效果，并使围护内水汽通过防水透汽膜顺畅排出，保护围护结构热功能性，从而达到节能的目的。

Application of Vapor Barrier

Vapor Barrier is a pitched roof underlay designed to:

1. Vapor Barrier improve the energy saving and insulation effect. Due to the unique water proof,when forming the protection to the insulation layer, it can also effectively avoid the negative influence from the temperature difference between interior and exterior. hence, it increasing the effects of insulation and energy saving as well as providing the continuously energy saving

2.The combined use of vapor Barrier and breathable roofing membrane can improve the residential environment .Because the interior vapour can natural exhaust,will effectively avoid mould and condensation,keep dry,permeate and comfortable indoor.

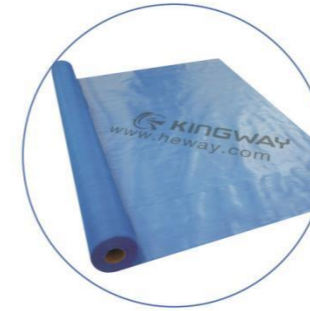
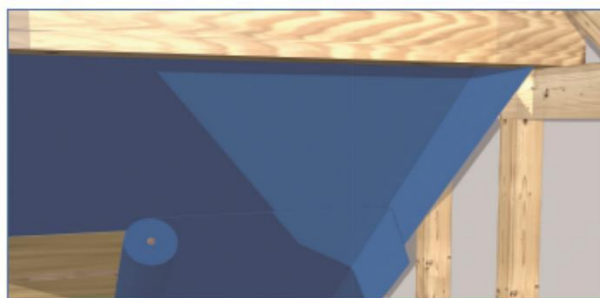
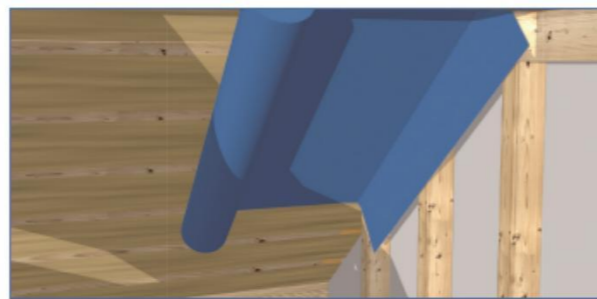

Non-vapour permeable underlay for roofing
 Mass per unit area: 100 g/m² (-)20 g / (+)10 g
 Reaction to fire: E
 Resistance to water penetration: W1
 Tensile strength (MD/XD): 160N/5 cm/ 100N/5 cm
 Elongation (MD/XD): 20-25 % / 20-25 %
 Resistance to tearing (MD/XD): 50 N (±)20% / 60 N (±)20%.



Polyethylene vapour control layer with mesh reinforcement.
 Straightness: <30 mm/10 m
 Mass per unit area: 100 g/m² (-)20 g / (+)10 g
 Reaction to fire: E
 Resistance to water penetration: W1
 Tensile strength (MD/XD): 300N/5 cm/ 240N/5 cm
 Elongation (MD/XD): 20-25 % / 20-25 %
 Resistance to tearing (MD/XD): 50 N (±)20% / 60 N (±)20%

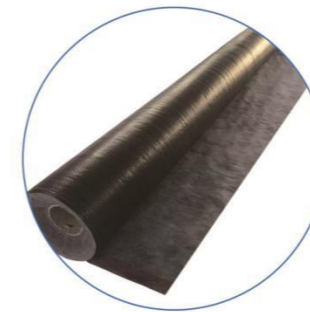

Woven PE underlay with non-woven fabric.
 Mass per unit area: 100 g/m² (±10 g/m²)
 Reaction to fire: E
 Resistance to water penetration: W1
 Water vapour resistance (Sd): ~35 m
 Tensile strength (MD/XD): 350 N/5 cm / 240N/5 cm
 Elongation (MD/XD): max. 30% / max. 30%
 Resistance to tearing (MD/XD): 100 N (±20%) / 100 N (±20%)

项目	类别	UB800	LENO100	NPP100	检测标准
厚度(mm)		≥0.3	≥0.35	≥0.3	无
气密性(g/m ² .24h)		≤10	≤10	≤10	GB/T1037-1998
水密性(mm/2h)		≥1500	≥2000	≥2000	GB/T328.10-2007
撕裂性能(N)	纵向	45	150	350	GB/5402-2003
	横向	65	180	300	
拉伸强度(N)	纵向	117	280	405	GB/T328.9-2007
	横向	80	180	350	
紫外线暴晒(天)		120	120	120	无



隔热膜



HEAT INSULATION MATERIAL

铝箔，镀铝膜复合无纺布，编织布，珍珠棉，玻璃纤维，牛皮纸等，用于保温、隔热及建筑等领域。

- 反射75%的太阳光，降低屋面温度；
- 高达95%的发射率，迅速散失屋面聚集的热量，保持屋面阴凉；
- 较低的热传导系数(0.058w/m.k)，阻止热量从表面到基材转移；
- 优良的耐腐蚀性，提高使用年限；
- 节省制冷所需的能源提高屋面使用年限；
- 倡导“节约”型社会理念，改善环境，减少污染，降低城市温度，避免城市“热岛效应”。

Selling points

- 1.Reflect over 90% thermal radiation
- 2.Excellent waterproofing performance
- 3.Over 20 years service life with good aging resistance
- 4.Flame resistance
- 5.Strong tensile strength and nail tearing resistance
6. Very thin,only 0.2mm.Ease of application

Energy Conservation Principle

Three methods of Heat transfer :conduction ,convection,radiation .In hot summer ,the temperature outside is much higher than indoor. The roof system and wall system absorb a lot of heat even sunset.Most heat is transferred by radiation,high temperature indoor is easy to cooling even we use air conditioner.Thermal Radiation.Insulation can reflect over 90% infrared heat to stop the roof an wall absorbing heat. People may feel more comfortable while air conditioner working at an energy conservation temperature.

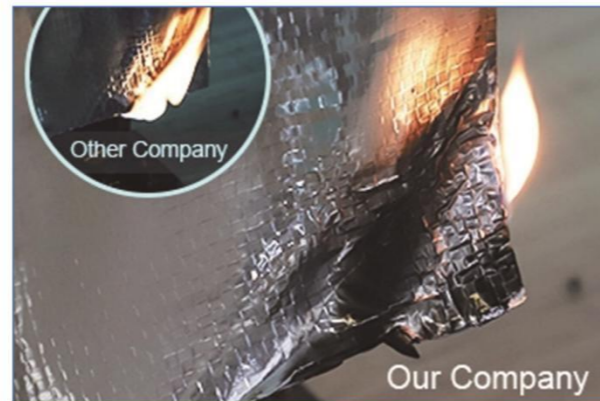

FSKE115 铝箔夹筋

single side foil-scrim-kraft facing

型号 : FSKE115		Model:FSKE115	
外观 : 银色		Appearance:silver	
结构 : 铝箔/聚乙烯/网格/牛皮纸/聚乙烯		Structure:Al Foil+PE+Scrim+Kraft Paper+PE	
规格 : 宽度 (cm) :100/120/150		Specification:width(cm):100/120/150	
长度 (cm) :100/200		length(m):100/200	
	测试方法		Testing method
克重 : 115g/m ²	天平	Weight:115g/m ²	Balance
抗张强度	ASTN C1136	Tensile strength	ASTN C1136
纵向 : 127/25mm		MD:127N/25mm	
横向 : 61N/25mm		CD:61N/25mm	
顶破强度 : 128N	ASTM D747	Bursting strength:128N	ASTM D747
耐温性能 : 4小时无分层 - 40°C/90°C	ASTM C1263	Temperture resistance: 4 hours no decladding - 40°C/90°C	ASTM C1263

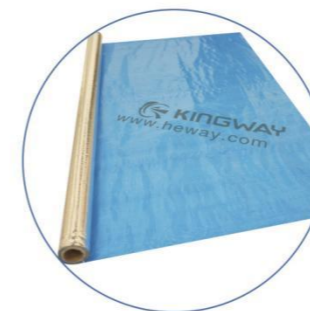

PFPE120 铝箔复合编织布

single side Al foil woven

型号 : PFPE120		Model:PFPE120	
外观 : 银色		Appearance:silver	
结构 : 铝箔/聚乙烯/编织布		Structure:Al Foil+PE+Woven	
规格 : 宽度 (cm) :100/120/150		Specification:width(cm):100/120/150	
长度 (cm) :50/100/200		length(m):50/100/200	
	测试方法		Testing method
克重 : 120g/m ²	天平	Weight:120g/m ²	Balance
抗张强度	GB/T328-9-2007	Tensile strength	GB/T328-9-2007
纵向 : 750N/50mm		MD:750N/50mm	
横向 : 700N/50mm		CD:700N/50mm	
不透水性 : 2000mm,2h	GB/T328.10-2007	Impermeability:2000mm,2h	GB/T328.10-2007
撕裂强度 : 纵向 : 520N 横向 : 500N	GB/T328.18-2007	tear strength:MD:520N CD:500N	GB/T328.18-2007



FPP100 铝膜复合无纺布

Al film nonwoven fabric

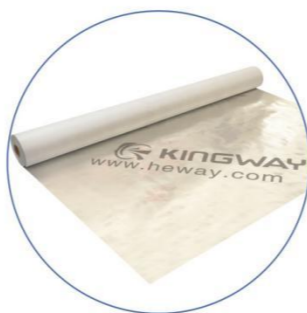

型号 : FPP100		Model:FPP100	
外观 : 银色		Appearance:silver	
结构 : 铝膜/聚乙烯/无纺布		Structure:Al Film+PE+Nonwoven fabric	
规格 : 宽度 (cm) :150		Specification:width(cm):150	
长度 (cm) :50/100/200		length(m):50/100/200	
	测试方法		Testing method
克重 : 100g/m ²	天平	Weight:100g/m ²	Balance
抗张强度	GB/T328-9-2007	Tensile strength	GB/T328-9-2007
纵向 : 160N/50mm		MD:160N/50mm	
横向 : 120N/50mm		CD:120N/50mm	
不透水性 : 2000mm,2h	GB/T328.10-2007	Impermeability:2000mm,2h	GB/T328.10-2007
撕裂强度 : 纵向 : 45N	GB/T328.18-2007	tear strength:MD:45N	GB/T328.18-2007
横向 : 70N		CD:70N	



DPF140 双面铝箔编织布

single side Al foil woven

型号 : DPF140		Model:DPF140	
外观 : 银色		Appearance:silver	
结构 : 铝箔/聚乙烯/编织布/聚乙烯/铝箔		Structure:Al Foil+PE+Woven+PE+Al Foil	
规格 : 宽度 (cm) :150		Specification:width(cm):150	
长度 (cm) :50/100/200		length(m):50/100/200	
	测试方法		Testing method
克重 : 140g/m ²	天平	Weight:140g/m ²	Balance
抗张强度	GB/T328-9-2007	Tensile strength	GB/T328-9-2007
纵向 : 500N/50mm		MD:500N/50mm	
横向 : 330N/50mm		CD:330N/50mm	
不透水性 : 2000mm,2h	GB/T328.10-2007	Impermeability:2000mm,2h	GB/T328.10-2007
撕裂强度 : 纵向 : 450N	GB/T328.18-2007	tear strength:MD:450N	GB/T328.18-2007
横向 : 380N		CD:380N	

FPE140 铝膜复合编织布

Al film woven



型号 : FPE140		Model:FPE140	
外观 : 银色		Appearance:silver	
结构 : 铝膜/聚乙烯/编织布		Structure:Al Film+PE+Woven	
规格 : 宽度 (cm) :150		Specification:width(cm):150	
长度 (cm) :50/100/200		length(m):50/100/200	
	测试方法		Testing method
克重 : 140g/m ²	天平	Weight:140g/m ²	Balance
抗张强度	GB/T328-9-2007	Tensile strength	GB/T328-9-2007
纵向 : 810N/50mm		MD:810N/50mm	
横向 : 800N/50mm		CD:800N/50mm	
不透水性 : 2000mm,2h	GB/T328.10-2007	Impermeability:2000mm,2h	GB/T328.10-2007
撕裂强度 : 纵向 : 520N	GB/T328.18-2007	tear strength:MD:520N	GB/T328.18-2007
横向 : 500N		CD:500N	



AI Leno90 铝膜复合网格

Al film mesh

型号 : AI Leno90		Model:AI Leno90	
外观 : 银色		Appearance:silver	
结构 : 铝膜/聚乙烯/网格布/聚乙烯		Structure:Al Film+PE+Mesh+PE	
规格 : 宽度 (cm) :150		Specification:width(cm):150	
长度 (cm) :50/100/200		length(m):50/100/200	
	测试方法		Testing method
克重 : 90g/m ²	天平	Weight:90g/m ²	Balance
抗张强度	GB/T328-9-2007	Tensile strength	GB/T328-9-2007
纵向 : 220N/50mm		MD:220N/50mm	
横向 : 150N/50mm		CD:150N/50mm	
不透水性 : 2000mm,2h	GB/T328.10-2007	Impermeability:2000mm,2h	GB/T328.10-2007
撕裂强度 : 纵向 : 250N	GB/T328.18-2007	tear strength:MD:250N	GB/T328.18-2007
横向 : 120N		CD:120N	



防水膜
waterproof membrane



产品描述



KINGWAY 防水膜卷的预期寿命长达 40 年，并提供极高的防水性，以防止其他湿气和水分渗入您的浴室墙壁、瓷砖和地板。防水卷材是一种刚性防水层，厚度均匀，易于贴合，防水层不会开裂、分层或剥离，不会失效。

使用防水膜确保您的工作，防水膜和蒸汽屏障可以很容易地将水挡在高湿度区域。防水膜易于安装，无需复杂的程序或额外的材料，密封性能值得信赖。

使用防水膜充满信心地完成每项工作，防水膜旨在通过经过验证的防水密封保护高湿度区域。

Finish every job confidently with the Waterproof Membrane, designed to protect high-moisture areas with a proven watertight seal.

Grips mortar with a signature double-sided fleece weave

Includes a watertight and acid-resistant blend of polyethylene and polypropylene

Resists salts, oils, solvents and other chemicals

Adheres with a thin-set or flex mortar

Provides optimal surface for thin-set tile

Requires less mortar for optimal adhesion

Prevents callbacks for damaged tile and grout

Cuts time spent sealing corners and edges with flexible material

Available in smaller size rolls, as sealing tape, and in pre-formed corner pieces

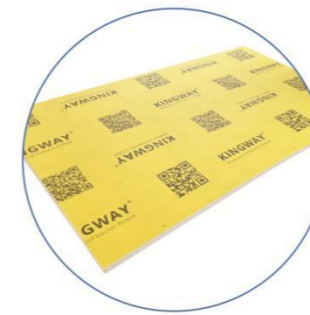

防水垫板
waterproof backer board

产品描述

KINGWAY 防水背板到货后即可使用。您受益于防水膜和水泥背板的组合，可帮助您更好地建造。安装在淋浴墙、工作台面和任何其他您想要防水且结构完整性完好的潮湿区域后面。

KINGWAY 防水背板使用起来既快捷又简单——它重量轻，不需要特殊工具，并且可以使用“划线和折断”方法进行切割。

与单独购买基材和防水材料相比成本更低。



KINGWAY WATERPROOF BACKER BOARD

When it comes to achieving a watertight seal, we have your back. The Kingway Waterproof Backer Board arrives ready to work.

You benefit from a watertight membrane and cement backer board combined to help you build better. Install behind shower walls, countertops, and any other wet areas where you want to keep water out—and structural integrity intact.

Made with a naturally occurring magnesium oxide, KINGWAY Waterproof Backer Board gives you the peace of mind that you are building with a durable board that is resistant to moisture, mold and mildew.

We use a proprietary nano-technology process to optimize the performance down to the molecular level

Designed to hold strong in water, it will not de-laminate, peel, rot, or swell

No toxic chemicals used, making it safe to install

Will not support mildew, mold, or fungal growth

Contractor and resident friendly, KINGWAY Waterproof Backer Board is free of crystalline silica, VOCs, and other harsh chemicals

Not subject to new OSHA regulations on crystalline silica



无纺布

PP NONWOVEN FABRIC

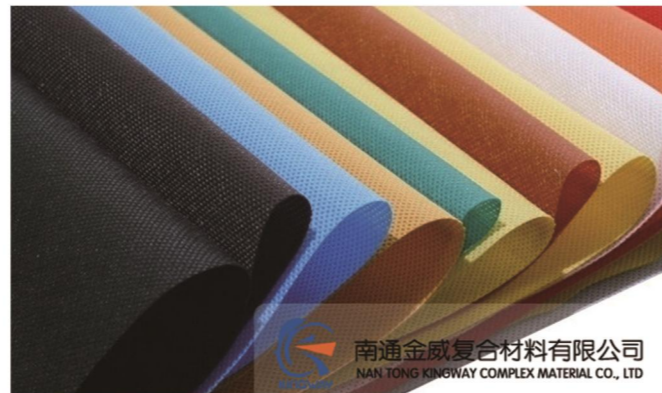
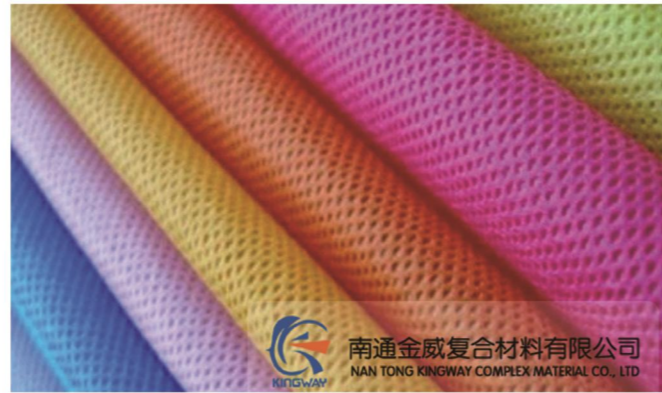
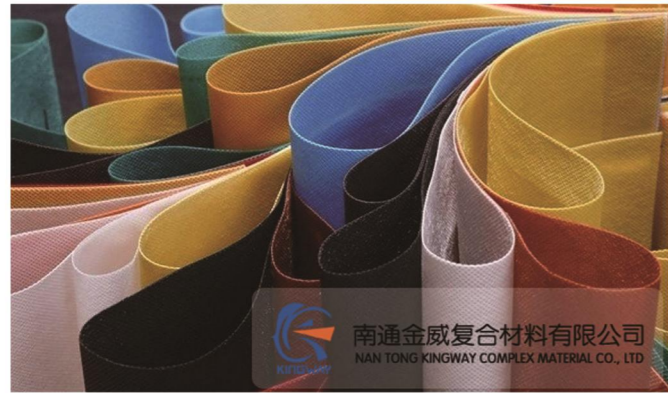

PP纺粘无纺布是一种非织造布：以100%聚丙烯为原料，采用科技先进设备，一条龙配套机组，经高温熔解，喷丝成型，多道热轧融合。其用途极其广泛，按其用途来分，大致可分为：服装用无纺布，箱包布、复合用布、皮革、制鞋用无纺布、家用装饰、家居无纺布、医疗卫生用无纺布。

公司产品广泛地应用于医疗卫生用品、隔离衣、防护服、手术衣帽、口罩、尿布、家纺用品、农业丰收布、购物袋、食品袋、土工布等众多领域。可为客户提供抗菌、抗静电、抗老化、阻燃、亲水等功能性无纺布。

公司本着“工作一丝不苟、质量精益求精、服务尽善尽美”的经营理念，产品以“质优价平”，迅速拓展中国市场，远销多个地区。我们愿以“金威精品”为纽带，与广大新老客户精诚合作，携手共进，共创美好未来！

公司郑重承诺：所有南通金威复合材料有限公司出品的无纺布材料，均为100%聚丙烯全颗粒料生产，无回收料和填充料。



PP polypropylene filament spunbond non-woven fabric is a kind of non-woven fabric: 100% polypropylene as raw material, advanced technology equipment, one-stop supporting unit, high temperature melting, spinning forming, and multiple hot rolling fusion. Its uses are extremely wide. According to its use, it can be roughly divided into: non-woven fabrics for clothing, cloth for luggage, composite fabrics, leather, non-woven fabrics for shoemaking, home decoration, non-woven fabrics for home use, and non-woven fabrics for medical and sanitary use. Woven cloth

The company's products are widely used in many fields such as medical and sanitary products, isolation gowns, protective clothing, surgical gowns, masks, sanitary products, diapers, home textile products, agricultural harvest cloths, shopping bags, food bags, geotextiles, etc. Can provide customers with antibacterial, antistatic, anti-aging, flame retardant, hydrophilic and other functional non-woven fabrics.



熔 喷 MELTBLOWN



熔喷布是口罩最核心的材料，熔喷布主要以聚丙烯为主要原料，纤维直径可以达到1~5微米。空隙多、结构蓬松、抗褶皱能力好。熔喷布具有独特的毛细结构，超细纤维增加单位面积纤维的数量和表面积，从而使熔喷布具有很好的过滤性、屏蔽性、绝热性和吸油性。

Meltblown nonwoven fabric is the core material of the mask. It is mainly made of polypropylene, and the fiber diameter can be up to 1 ~ 5 microns. Meltblown nonwoven fabric has the characteristics of more voids, fluffy structure and good drape resistance. Melt-blown fabric has unique capillary structure of superfine fiber. It increases the number of fibers per unit area and surface area, so that the melt-blown fabric has the very good filterability, shielding, insulation, and oil absorption.



产品参数

PFE (0.3微米) 过滤效率	幅宽/width	克重/weight	颜色/color
≥95%, ≥99%	175mm-1600mm	25-80g	白色/white; 蓝色/blue

熔喷布还可用于空气、液体过滤材料、隔离材料、吸纳材料、口罩材料、保暖材料、吸油材料及擦拭布等领域。

Meltblown nonwoven fabric also can be used in air, liquid filtration materials, isolation materials, absorbing materials, mask materials, thermal insulation materials, oil-absorbing materials and wiping cloth and other fields.

PE透汽膜 PE BREATHABLE FILM

PE透汽膜是一种新型高分子防水材料，其主要成分是聚乙烯。从制作工艺上讲，技术要求比其他防水材料高得多；同时从品质上来看，该种透汽膜也具有其他防水材料所不具备的特点。

- (1) 它能够透过气体但不透水，所以能够作为防水材料使用，具有防潮性。
- (2) 可以适当地改善使用者小环境的空气对流，有利于肌肤呼吸。
- (3) 由于其原料的特性，PE膜属于环保材料，不损害环境。



PE breathable film is a new kind of high polymer waterproof material, its main component is polyethylene. From the production process, the technical requirements are much higher than other waterproof materials; At the same time, from the point of quality, This kind of breathable film also has the characteristics that other waterproof materials do not have.

- (1) It can pass through gas but is impermeable to water, so it can be used as a waterproof material, with moisture resistance.
- (2) It can properly improve the air convection in the user's small environment, which is conducive to skin respiration.
- (3) Due to the characteristics of its raw materials, PE film is an environmentally friendly material and does not damage the environment.



医用防护 DISPOSABLE MEDICAL PRODUCT

1. 透汽膜复合类无纺布（最宽门幅1.8米），无尘纸复合无纺布或透汽膜或PE膜产品采用微孔透汽膜与无纺布复合而成，手感柔软、透汽防渗，产品广泛应用于防护服、手术衣、床单等医疗卫生及防护领域。
2. 淋膜无纺布，涂膜克重从10-60克。采用不同颜色的无纺布与不同颜色的膜复合，可以生产出不同规格的产品，门幅最宽2.1米。多层贴合（水刺布/膜皱纹纸，无纺布/膜/无纺布/，短丝布/膜/皱纹纸，膜/无纺布/膜）产品广泛应用于一次性医用床单，铺单，枕套，宠物垫。
3. 防滑复合等功能性材料。

Main products: Nonwoven fabrics SF, SFS, SMS, PE film coated with dust free Multi-layer lamination (sunlace/film/wrinkle paper, film/noven/film), nonwoven coating anti-slip PE

Features:

1. good tearing strength, waterproof, good breathability, soft handle
2. Excellent performance breathable membrane
3. Eco-friendly to be completely recyclable
4. Antistatic, UV resistant
5. Weight: From 25gsm to 300gsm
6. Max width: 2.1m

The lamination material can be used to produce disposable surgical gowns, isolation gowns, surgical drapes, instrument table covers, bedsheets, waterproof sheets, shoes covers, dental bibs, ice bags, adhesive tape, etc.



防护效果

- 01 透气性好**
采用透气面料，单向透汽、抑菌，能挥发内部热气。
- 02 防细小颗粒**
可过滤细小颗粒物、粉尘等。
- 03 防护隔离**
防护隔离外部各种液体，过滤挥发性气体，避免直接接触。

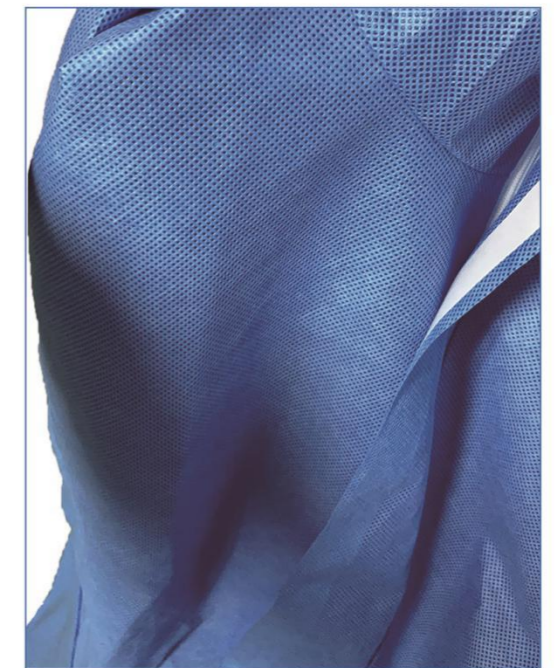

◆ SF防护服面料检测报告/SF Test report



◆ SMS检测报告/Test report





PE网格布

PE MESH

PE网格布夹网布，夹网材料是两层LDPE薄膜中加入超强PE网格复合而成，被广泛用于建筑防水，花房暖房，广告，包装材料，农用大棚和透视门帘等相关领域。宽度为2.05米，长度可根据客户需求定制。

PE tarpalulin: PE film coated with mesh and PE film for waterproof
 Features: good tearing strength, waterproof, UV resistance, Eco-friendly
 Weight: from 90gsm-400gsm
 Max Width: 2.05m
 Others as buyers requirements

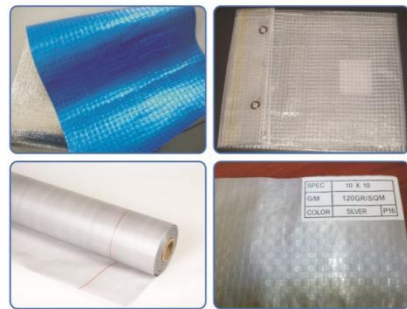

DATASHEET Vapour Control Layer					
		125	125 SE	170 SE	
CONSTRUCTION					
Raw material Fabric		HDPE	HDPE	HDPE	
Raw material Coating		LDPE/alu damped		LDPE/ALU	
Colour		Transp.	white	white	
MECHANICAL PROPERTIES					
Warp direction:					
Tensile strength	N/5 cm	350	350	350	prEN 13859-1/2
Elongation at maximum strength	%	24	24	24	prEN 13859-1/2
Nail tear resistance	N	150	150	150	prEN 13859-1/2
Weft direction:					
Tensile strength	N/5 cm	220	220	220	prEN 13859-1/2
Elongation at maximum strength	%	25	25	25	prEN 13859-1/2
Nail tear resistance	N	150	150	150	prEN 13859-1/2
FLAME RETARDANCY					
Flame retardant	class	-	-	-	DIN 4102
UV-STABILITY					
UV Stability	MJ	50	50	50	prEN 13859C
PERMEABILITY					
Water vapour permeability	g/m ² /day	1	1	1	
Sd-Value	m	40	40	40	
Water vapour transmission	Mns/ g	-	-	0.5	BS 3177
Watertightness	Class	W1	W1	W1	prEN 13859-1/2
PHYSICAL PROPERTIES					
Weight	g/m ²	125	125	170	EN 965
Thickness (inclusive Fabric)	micron	500	500	550	EN 964-1
Thickness (exclusive Fabric)	micron	100	100	130	

包装材料

PACKING MATERIALS

我公司生产的无纺布以及复合产品，牛皮纸，铝膜，铝箔复合产品广泛应用于包装材料。

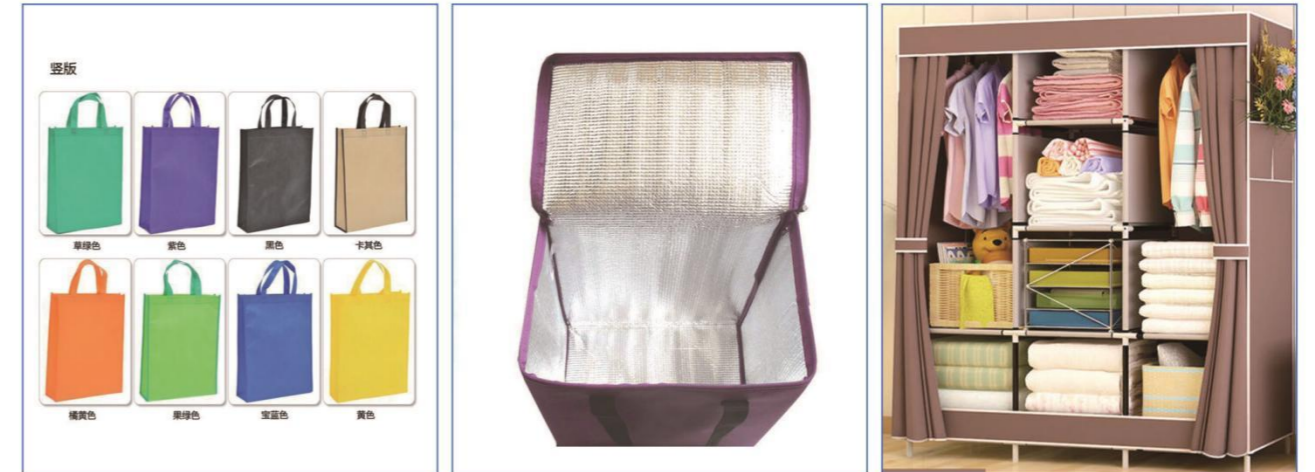



一路走来 感恩有你 厚积薄发 共赢未来

部分合作伙伴



上海宝冶集团有限公司
SHANGHAI BAOYE GROUP CORP., LTD.



一路走来 感恩有你 厚积薄发 共赢未来

以全球化的视野，成为您可信赖的合作商！

